

PELLA CORPORATION

IMPERVIA 2.0 IMPACT DIRECT SET (NON-HVHZ) (IMPACT)



102 MAIN ST.
PELLA, IA 50219
PH: (641) 621-6096

GENERAL NOTES:

- THE PRODUCT SHOWN HEREIN IS DESIGNED AND MANUFACTURED TO COMPLY WITH THE CURRENT EDITION FLORIDA BUILDING CODE (FBC), **EXCLUDING HVHZ**, AND HAS BEEN EVALUATED ACCORDING TO THE FOLLOWING:
 - ASTM E1886-13A
 - ASTM E1996-17
 - AAMA/WDMA/CSA 101/I.S.2/A440-11/17
- ADEQUACY OF THE EXISTING STRUCTURAL CONCRETE/MASONRY, 2X FRAMING, AND METAL FRAMING AS A MAIN WIND FORCE RESISTING SYSTEM CAPABLE OF WITHSTANDING AND TRANSFERRING APPLIED PRODUCT LOADS TO THE FOUNDATION IS THE RESPONSIBILITY OF THE ENGINEER OR ARCHITECT OF RECORD FOR THE PROJECT OF INSTALLATION.
- 1X AND 2X BUCKS (WHEN USED) SHALL BE DESIGNED AND ANCHORED TO PROPERLY TRANSFER ALL LOADS TO THE STRUCTURE. BUCK DESIGN AND INSTALLATION IS THE RESPONSIBILITY OF THE ENGINEER OR ARCHITECT OF RECORD FOR THE PROJECT OF INSTALLATION.
- THE INSTALLATION DETAILS DESCRIBED HEREIN ARE GENERIC AND MAY NOT REFLECT ACTUAL CONDITIONS FOR A SPECIFIC SITE. IF SITE CONDITIONS CAUSE INSTALLATION TO DEVIATE FROM THE REQUIREMENTS DETAILED HEREIN, A LICENSED ENGINEER OR ARCHITECT SHALL PREPARE SITE SPECIFIC DOCUMENTS FOR USE WITH THIS DOCUMENT IN NON-HVHZ AREAS.
- APPROVED IMPACT PROTECTIVE SYSTEM **IS NOT REQUIRED** ON THIS PRODUCT IN WIND ZONE 2 OR LESS.
- APPROVED IMPACT PROTECTIVE SYSTEM **IS REQUIRED** ON THIS PRODUCT IN WIND ZONE 3 OR MORE.
- WINDOW FRAME MATERIAL: FIBERGLASS COMPOSITE
- GLASS MEETS THE REQUIREMENTS OF ASTM E 1300 GLASS CHARTS. SEE SHEET 1 FOR GLAZING DETAILS.

MAX. WINDOW FRAME SIZE		CONFIG.	DESIGN PRESSURE	GLASS TYPE	MISSILE IMPACT RATING
WIDTH	HEIGHT				
59.5"	73.5"	O	+50/-55 PSF	G1	MISSILE LEVEL C
37.5"	73.5"	O	+50/-55 PSF	G2/G2A	
120"	60"	O	+50/-55 PSF	G3/G3A	

TABLE OF CONTENTS	
SHEET	SHEET DESCRIPTION
1	GENERAL NOTES & GLAZING DETAILS
2	ELEVATIONS & ANCHOR LAYOUTS
3	ELEVATION & ANCHOR LAYOUTS
4	VERTICAL SECTION
5	HORIZONTAL SECTION
6	INSTALLATION NOTES & ANCHOR DETAILS

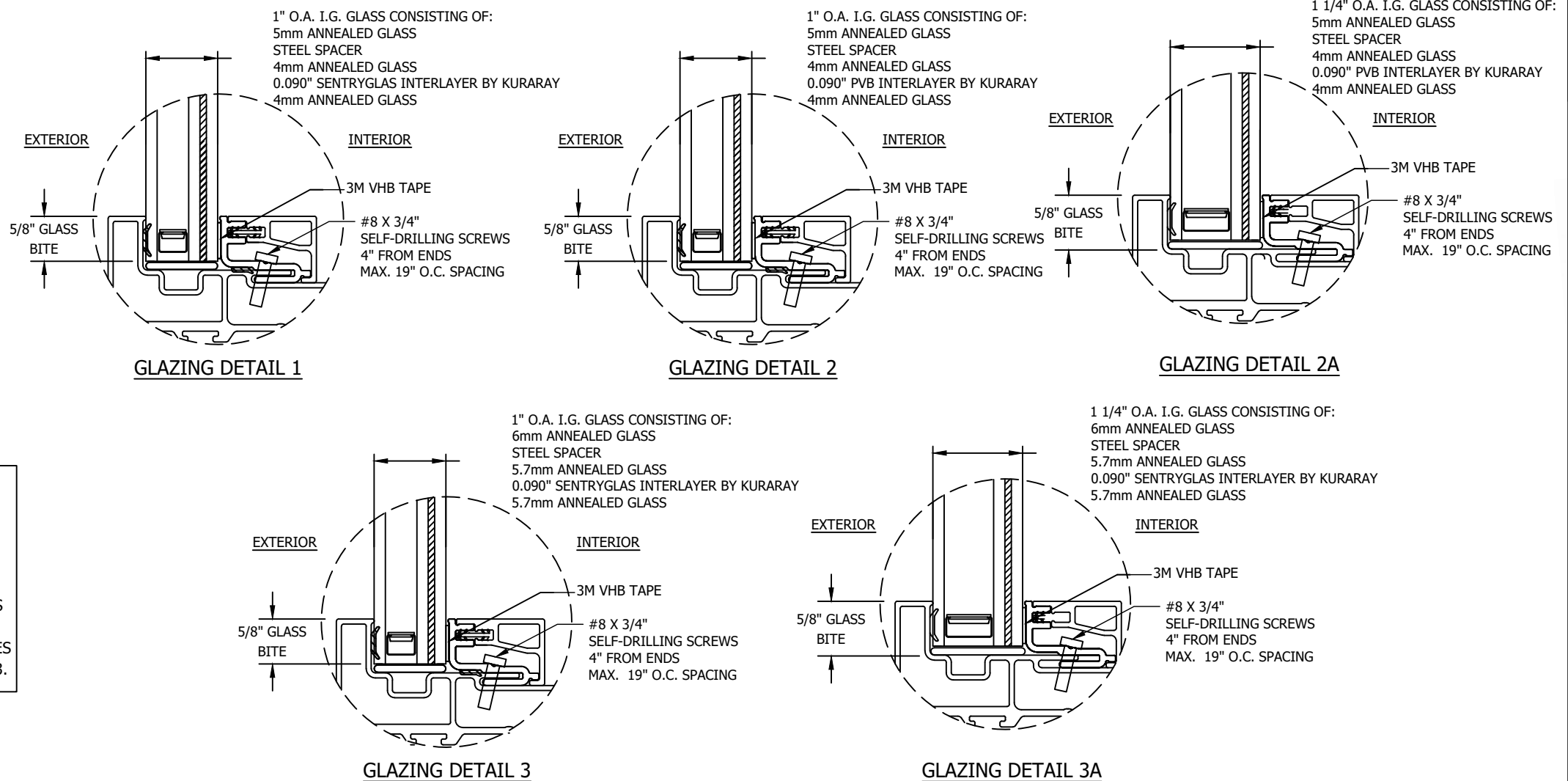

- ### GLAZING NOTES:
- GLASS TYPE COMPLIES WITH ASTM E1300 REQUIREMENTS.
 - TEMPER AND SAFETY GLAZING REQUIREMENTS SHALL BE REVIEWED ON A SITE SPECIFIC BASIS.
 - SETTING BLOCK DUROMETER HARDNESS OF 70-90 (SHORE A) AS REFERENCED IN FBC CHAPTER 24.
 - TWO APPROVED SETTING BLOCKS SHALL BE USED FOR GLASS WIDER THAN 36" AS PER FBC CHAPTER 24.
 - D.L.O. AND DESIGN PRESSURES MAY NOT EXCEED MAX VALUES IN DP TABLE ON SHEET 1, AND ELEVATIONS ON SHEETS 2 & 3.

TITLE: IMPERVIA 2.0 IMPACT DIRECT SET (NON-HVHZ) (IMPACT)
GENERAL NOTES & GLAZING DETAILS

PREPARED BY: BUILDING DROPS, INC.
398 E. DANIA BEACH BLVD., STE. 338
DANIA BEACH, FL 33004
PH: (954)399-8478
FAX: (954)744-4738
WEB: www.buildingdrops.com

REMARKS | **BY** | **DATE**

THE INSTALLATION DETAILS DESCRIBED HEREIN ARE GENERIC AND MAY NOT REFLECT ACTUAL CONDITIONS FOR A SPECIFIC SITE. IF SITE CONDITIONS CAUSE INSTALLATION TO DEVIATE FROM THE REQUIREMENTS DETAILED HEREIN, A LICENSED ENGINEER OR ARCHITECT SHALL PREPARE SITE SPECIFIC DOCUMENTS FOR USE WITH THIS DOCUMENT.

HERMES F. NORERO
LICENSE
No. 73778
STATE OF FLORIDA
PROFESSIONAL ENGINEER
HERMES F. NORERO, P.E.
FLORIDA P. E. NO. 73778
398 E. DANIA BEACH BLVD., STE. 338
DANIA BEACH, FL 33004
FBPE CERT. OF AUTHORIZATION NO. 29578

FL26584

DATE: 06/23/23

DWG. BY: OL | CHK. BY: HFN

SCALE: NTS

DWG. #: PLA001

SHEET: OF 6

1



102 MAIN ST.
PELLA, IA 50219
PH: (641) 621-6096

INSTALLATION LEGEND:
— THROUGH FRAME
▬ CLIP

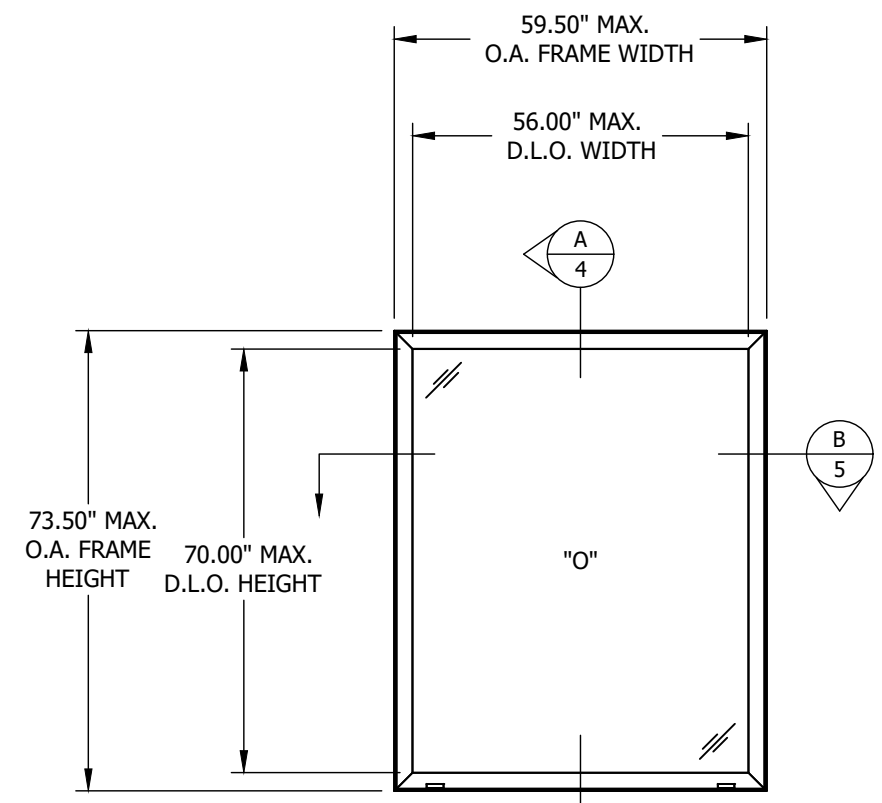

ELEVATION
DIRECT SET WINDOW

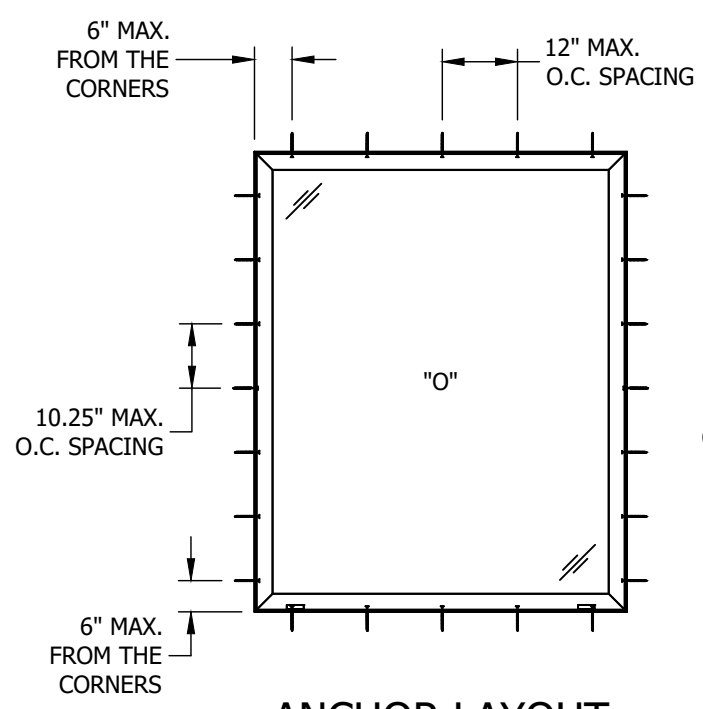

ANCHOR LAYOUT
THROUGH FRAME INSTALLATION

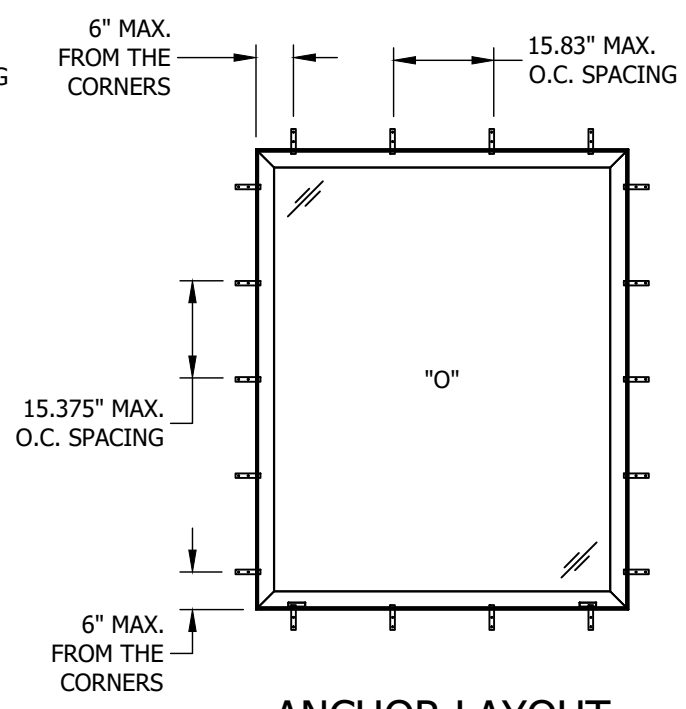

ANCHOR LAYOUT
CLIP INSTALLATION

NOTE: TWO (2) INSTALLATION ANCHORS PER CLIP LOCATION.

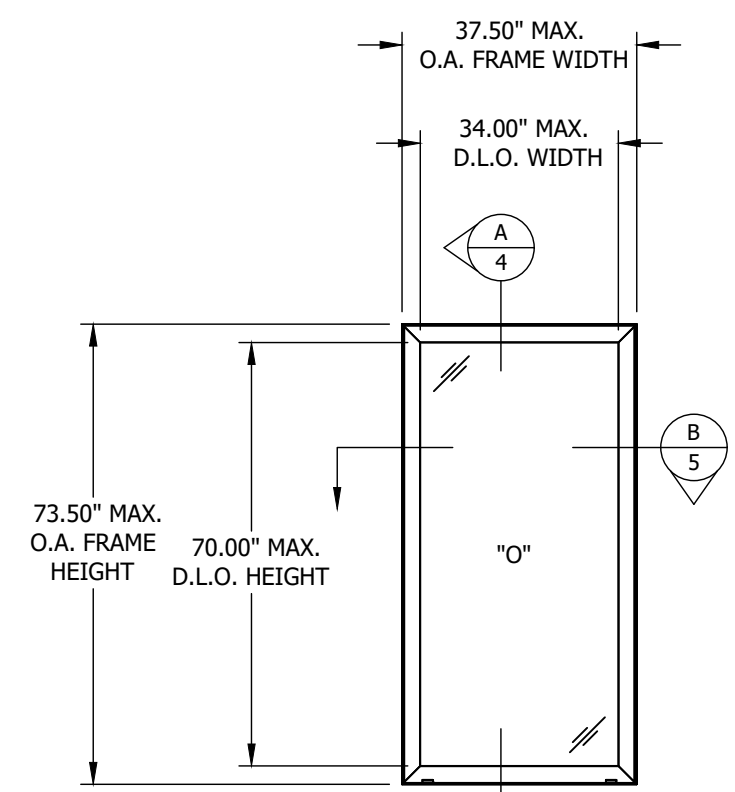

ELEVATION
DIRECT SET WINDOW

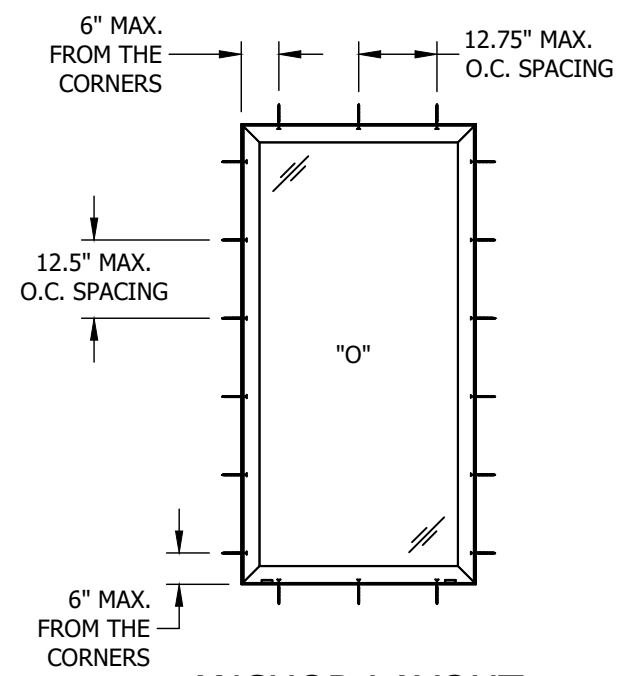

ANCHOR LAYOUT
THROUGH FRAME INSTALLATION

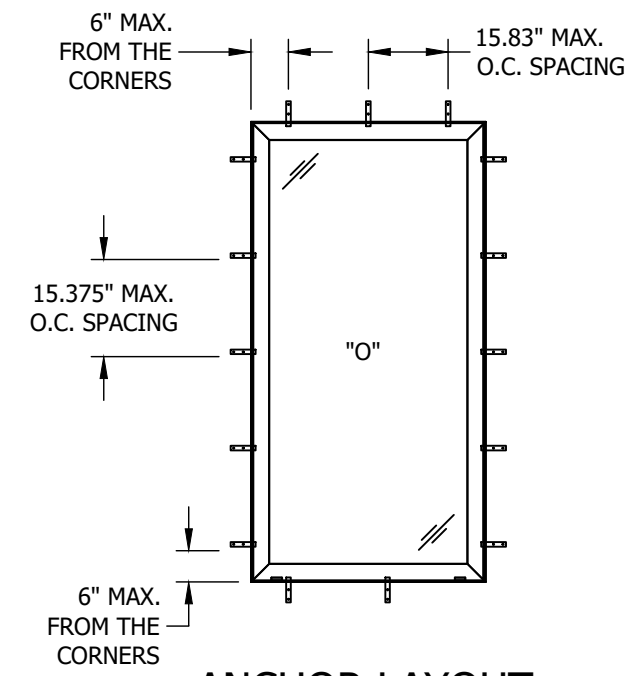

ANCHOR LAYOUT
CLIP INSTALLATION

TITLE: IMPERVIA 2.0 IMPACT DIRECT SET (NON-HVHZ) (IMPACT)
ELEVATIONS & ANCHOR LAYOUTS

PREPARED BY: **BD BUILDING DROPS**

BUILDING DROPS, INC.
398 E. DANIA BEACH BLVD., STE. 338
DANIA BEACH, FL 33004
PH: (954)399-8478
FAX: (954)744-4738
WEB: www.buildingdrops.com

REMARKS	BY	DATE

THE INSTALLATION DETAILS DESCRIBED HEREIN ARE GENERIC AND MAY NOT REFLECT ACTUAL CONDITIONS FOR A SPECIFIC SITE. IF SITE CONDITIONS CAUSE INSTALLATION TO DEVIATE FROM THE REQUIREMENTS DETAILED HEREIN, A LICENSED ENGINEER OR ARCHITECT SHALL PREPARE SITE SPECIFIC DOCUMENTS FOR USE WITH THIS DOCUMENT.

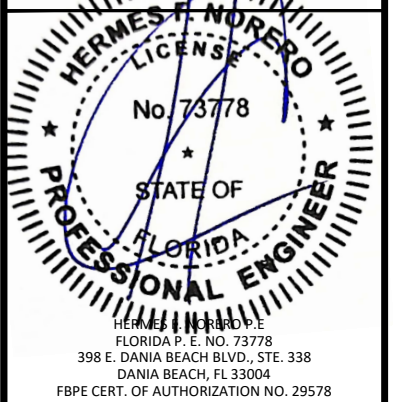

FL26584

DATE: 06/23/23

DWG. BY: OL CHK. BY: HFN

SCALE: NTS

DWG. #: PLA001

SHEET: OF 6

2



102 MAIN ST.
PELLA, IA 50219
PH: (641) 621-6096

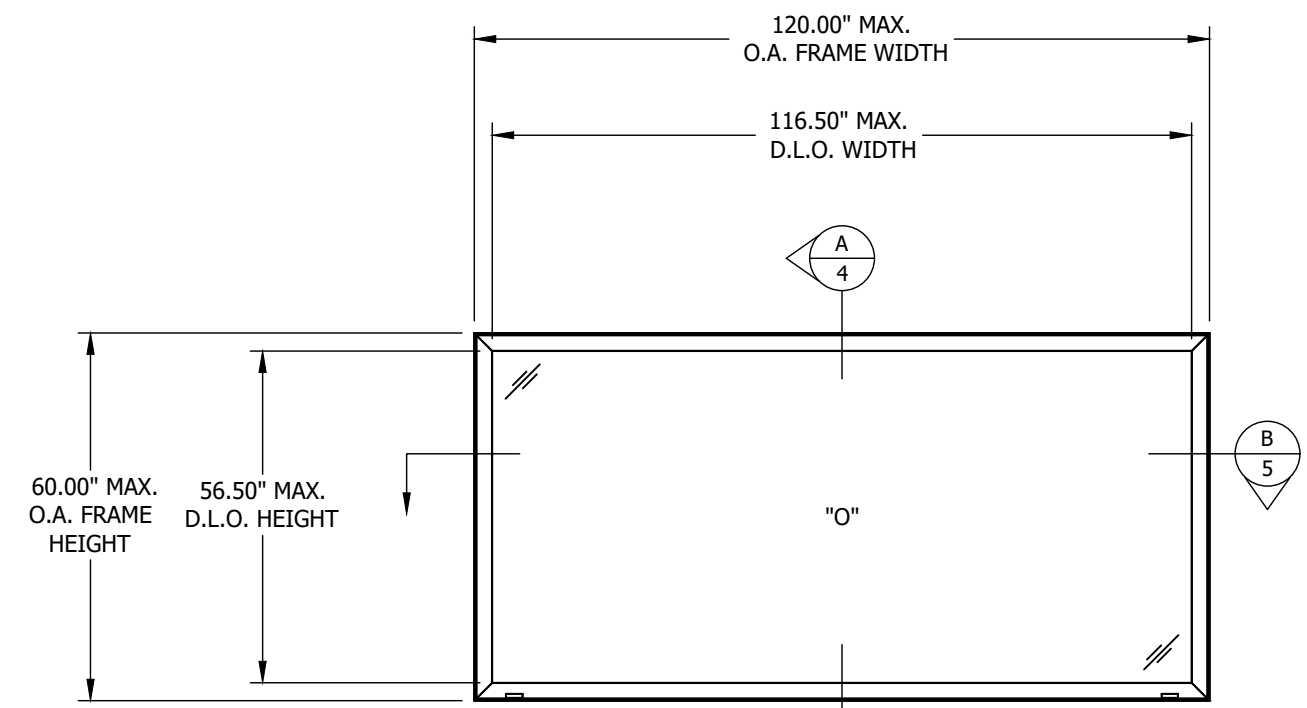

ELEVATION
DIRECT SET WINDOW

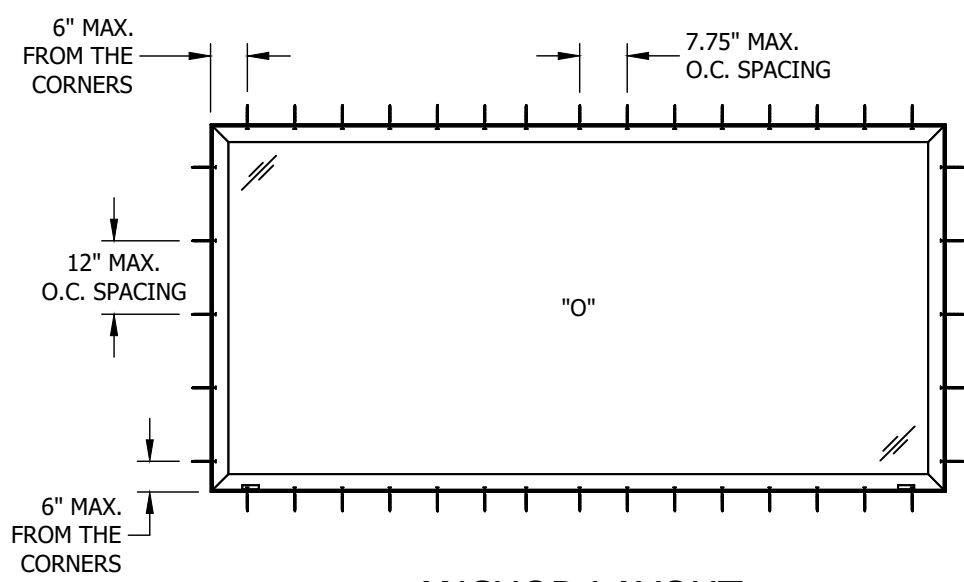

ANCHOR LAYOUT
THROUGH FRAME INSTALLATION

INSTALLATION LEGEND:
— THROUGH FRAME
= CLIP

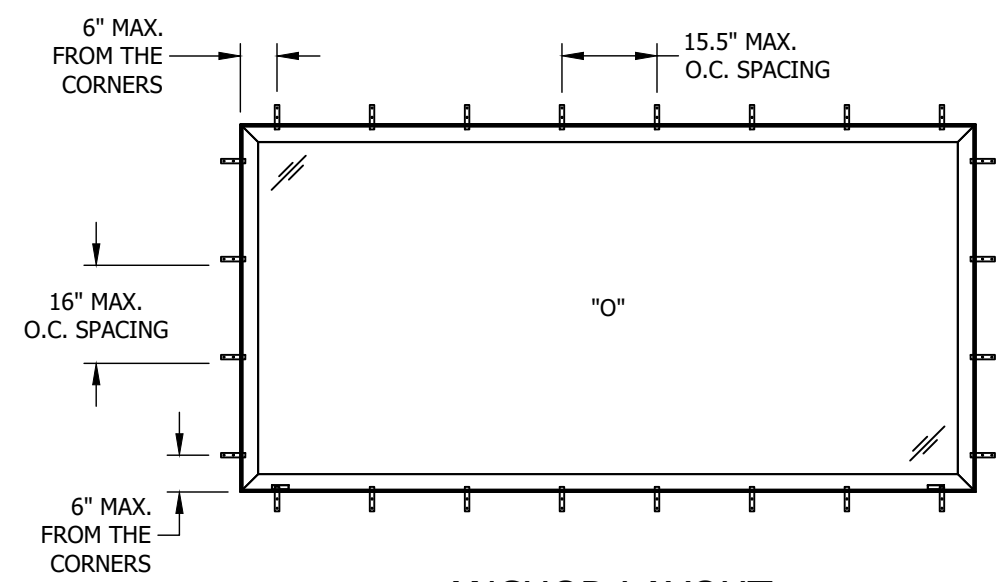

ANCHOR LAYOUT
CLIP INSTALLATION

NOTE: TWO (2) INSTALLATION ANCHORS
PER CLIP LOCATION.

TITLE:
**IMPERVIA 2.0 IMPACT DIRECT SET
(NON-HVHZ) (IMPACT)**
ELEVATION & ANCHOR LAYOUTS

PREPARED BY:
BUILDING DROPS, INC.
398 E. DANIA BEACH BLVD., STE. 338
DANIA BEACH, FL 33004
PH: (954)399-8478
FAX: (954)744-4738
WEB: www.buildingdrops.com



REMARKS	BY	DATE

THE INSTALLATION DETAILS DESCRIBED HEREIN ARE GENERIC AND MAY NOT REFLECT ACTUAL CONDITIONS FOR A SPECIFIC SITE. IF SITE CONDITIONS CAUSE INSTALLATION TO DEVIATE FROM THE REQUIREMENTS DETAILED HEREIN, A LICENSED ENGINEER OR ARCHITECT SHALL PREPARE SITE SPECIFIC DOCUMENTS FOR USE WITH THIS DOCUMENT.

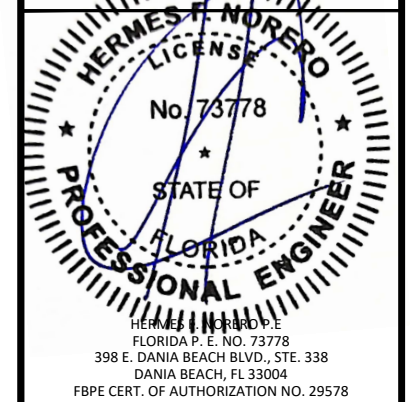

FL26584

DATE:	06/23/23	
DWG. BY:	OL	CHK. BY: HFN
SCALE:	NTS	
DWG. #:	PLA001	
SHEET:	3	OF 6

3



102 MAIN ST.
PELLA, IA 50219
PH: (641) 621-6096

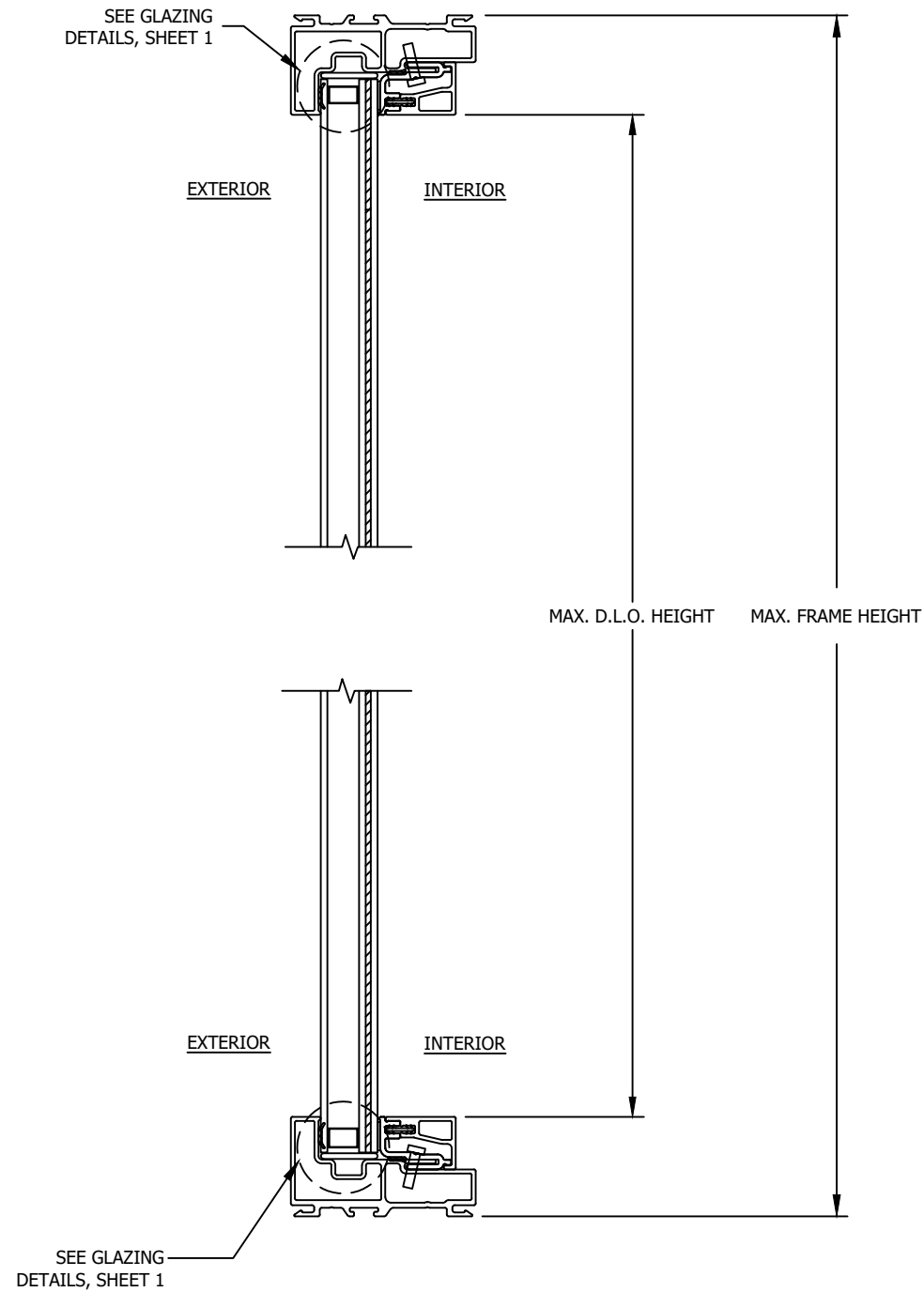

A
4 VERTICAL SECTION
HEAD/SILL

TITLE:
IMPERVIA 2.0 IMPACT DIRECT SET
(NON-HVHZ) (IMPACT)
VERTICAL SECTION

PREPARED BY:
BD
BUILDING DROPS

BUILDING DROPS, INC.
398 E. DANIA BEACH BLVD., STE. 338
DANIA BEACH, FL 33004
PH: (954)399-8478
FAX: (954)744-4738
WEB: www.buildingdrops.com

REMARKS	BY	DATE

THE INSTALLATION DETAILS DESCRIBED HEREIN ARE GENERIC AND MAY NOT REFLECT ACTUAL CONDITIONS FOR A SPECIFIC SITE. IF SITE CONDITIONS CAUSE INSTALLATION TO DEVIATE FROM THE REQUIREMENTS DETAILED HEREIN, A LICENSED ENGINEER OR ARCHITECT SHALL PREPARE SITE SPECIFIC DOCUMENTS FOR USE WITH THIS DOCUMENT.

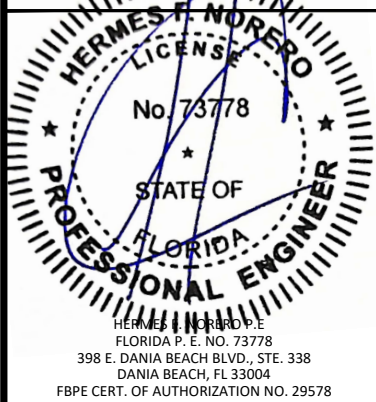

FL26584

DATE: 06/23/23

DWG. BY: OL CHK. BY: HFN

SCALE: NTS

DWG. #: PLA001

SHEET: OF 6



102 MAIN ST.
PELLA, IA 50219
PH: (641) 621-6096

TITLE: IMPERVIA 2.0 IMPACT DIRECT SET
(NON-HVHZ) (IMPACT)
HORIZONTAL SECTION

PREPARED BY:
BD
BUILDING DROPS



BUILDING DROPS, INC.
398 E. DANIA BEACH BLVD., STE. 338
DANIA BEACH, FL 33004
PH: (954)399-8478
FAX: (954)744-4738
WEB: www.buildingdrops.com

REMARKS	BY	DATE

THE INSTALLATION DETAILS DESCRIBED HEREIN ARE GENERIC AND MAY NOT REFLECT ACTUAL CONDITIONS FOR A SPECIFIC SITE. IF SITE CONDITIONS CAUSE INSTALLATION TO DEVIATE FROM THE REQUIREMENTS DETAILED HEREIN, A LICENSED ENGINEER OR ARCHITECT SHALL PREPARE SITE SPECIFIC REQUIREMENTS FOR USE WITH THIS DOCUMENT.

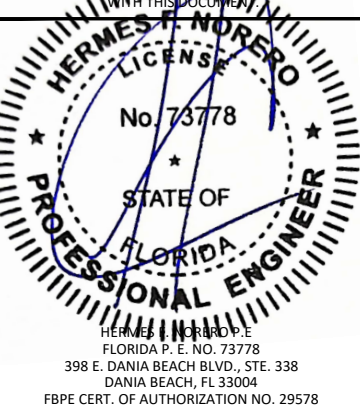

FL26584

DATE: 06/23/23

DWG. BY: OL	CHK. BY: HFN
----------------	-----------------

SCALE: NTS

DWG. #: PLA001

SHEET: 5 OF 6

5

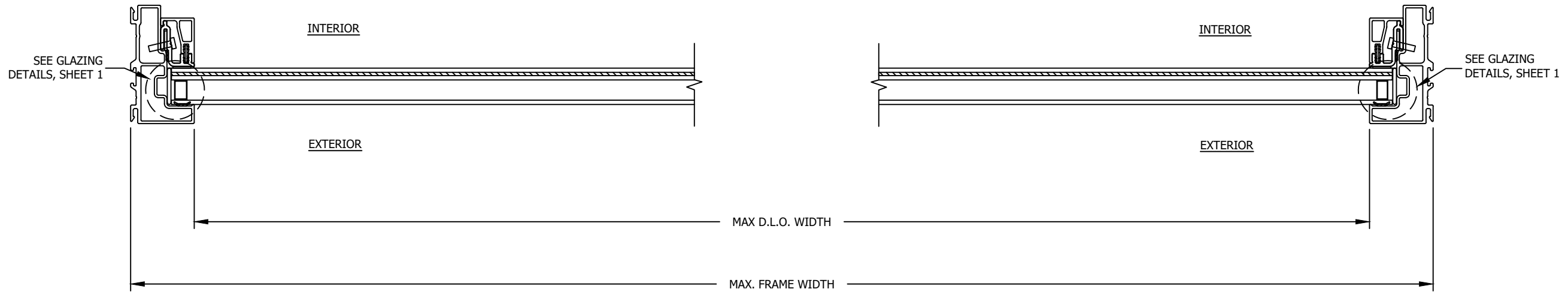

B
5 HORIZONTAL SECTION
JAMB

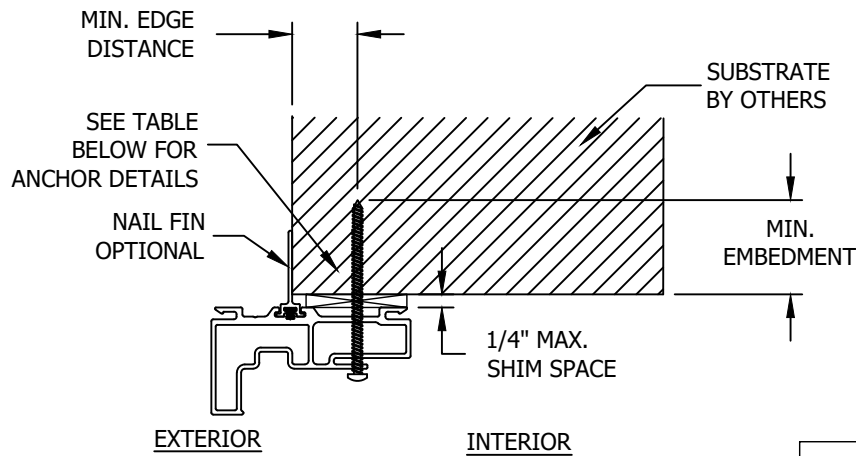

NOTE: HEAD SHOWN, JAMB & SILL SIMILAR

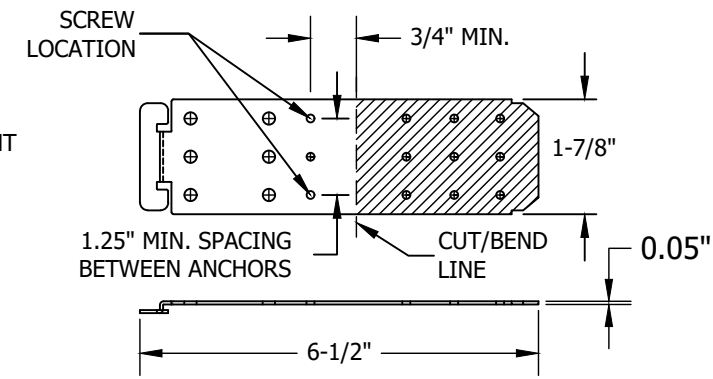
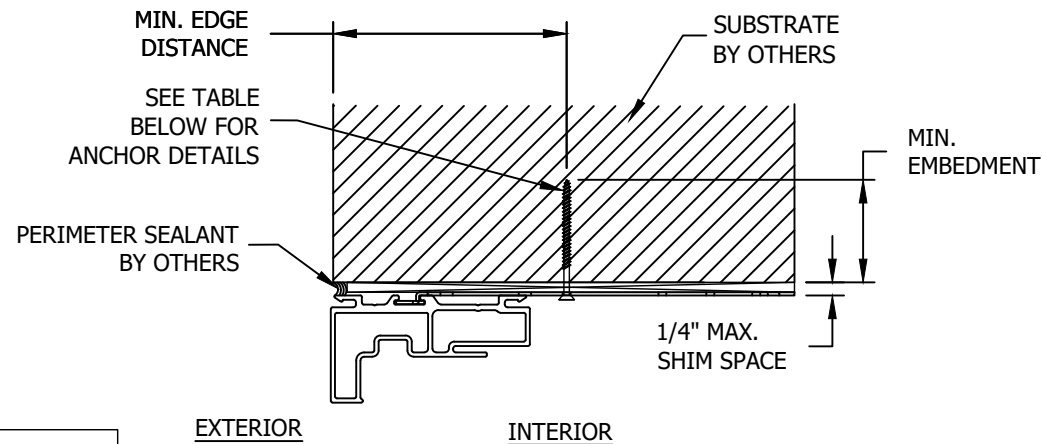

NOTE: EXCESS CLIP TAB MAY BE CUT OFF OR BENT OVER THE SUBSTRATE

A
6 ANCHOR DETAIL
THROUGH FRAME INSTALLATION (HEAD)

B
6 ANCHOR DETAIL
CLIP INSTALLATION (HEAD)

C
6 INSTALLATION CLIP
STEEL

INSTALLATION NOTES:

- ONE (1) INSTALLATION ANCHOR IS REQUIRED AT EACH ANCHOR LOCATION SHOWN.
- THE NUMBER OF INSTALLATION ANCHORS DEPICTED IS THE MINIMUM NUMBER OF ANCHORS TO BE USED FOR PRODUCT INSTALLATION OF THE MAXIMUM SIZE LISTED.
- INSTALL INDIVIDUAL INSTALLATION ANCHORS WITHIN A TOLERANCE OF $\pm 1/2$ INCH THE DEPICTED LOCATION & SPACING IN THE ANCHOR LAYOUT DETAILS (I.E., WITHOUT CONSIDERATION OF TOLERANCES). TOLERANCES ARE NOT CUMULATIVE FROM ONE INSTALLATION ANCHOR TO THE NEXT.
- SHIM AS REQUIRED AT EACH INSTALLATION ANCHOR WITH LOAD BEARING SHIM(S). MAXIMUM ALLOWABLE SHIM STACK TO BE 1/4" INCH. SHIM WHERE SPACE OF 1/16 INCH OR GREATER OCCURS. SHIM(S) SHALL BE CONSTRUCTED OF HIGH DENSITY PLASTIC OR BETTER.
- FOR MASONRY OR CONCRETE OPENINGS, 1X WOOD BUCK MAY BE USED (OPTIONAL AS LONG AS THE MINIMUM EMBEDMENT AND EDGE DISTANCE REQUIREMENTS ARE STILL MET WITHIN THE CORRESPONDING HOST SUBSTRATE. SEE GENERAL NOTE #3 ON SHEET 1 FOR MORE INFORMATION.
- MINIMUM EMBEDMENT AND EDGE DISTANCE EXCLUDE WALL FINISHES, INCLUDING BUT NOT LIMITED TO STUCCO, FOAM, BRICK VENEER, AND SIDING.
- INSTALLATION ANCHORS AND ASSOCIATED HARDWARE MUST BE MADE OF CORROSION RESISTANT MATERIAL OR HAVE A CORROSION RESISTANT COATING.
- FOR HOLLOW BLOCK AND GROUT FILLED BLOCK, DO NOT INSTALL INSTALLATION ANCHORS INTO MORTAR JOINTS. EDGE DISTANCE IS MEASURED FROM FREE EDGE OF BLOCK OR EDGE OF MORTAR JOINT INTO FACE SHELL OF BLOCK.
- INSTALLATION ANCHORS SHALL BE INSTALLED IN ACCORDANCE WITH ANCHOR MANUFACTURER'S INSTALLATION INSTRUCTIONS, AND ANCHORS SHALL NOT BE USED IN SUBSTRATES WITH STRENGTHS LESS THAN THE MINIMUM STRENGTH SPECIFIED BY THE ANCHOR MANUFACTURER.

ANCHOR SCHEDULE						
METHOD	SUBSTRATE TYPE	SUBSTRATE	ANCHOR TYPE	MIN. EMBEDMENT	MIN. EDGE DISTANCE	SPACING
THROUGH FRAME	A	WOOD: MIN. SG = 0.55	#10 WOOD SCREW	1.50"	0.75"	SEE SHEETS 2 & 3
	B	METAL: 18 GAUGE STEEL, MIN. F _y = 33KSI ALUMINUM .125" MIN, 6063-T5 MIN	#10 SELF DRILLING SCREW	3 THREADS MIN. PENETRATION BEYOND METAL	0.50"	
	C	CONCRETE: f _c =3000PSI	3/16" ITW TAPCON	1.25"	2.00"	
	D	MASONRY: CMU PER ASTM C90 MIN. 2000 PSI		1.00"	2.00"	
CLIP INSTALLATION	A	WOOD: MIN. SG = 0.55	#8 WOOD SCREW	1.50"	0.75"	SEE SHEETS 2 & 3
	B	METAL: 18 GAUGE STEEL, MIN. F _y = 33KSI ALUMINUM .125" MIN, 6063-T5 MIN	#8 SELF DRILLING SCREW	3 THREADS MIN. PENETRATION BEYOND METAL	0.50"	
	C	CONCRETE: f _c =3000PSI	3/16" ITW TAPCON	1.25"	2.00"	
	D	MASONRY: CMU PER ASTM C90 MIN. 2000 PSI		1.00"	2.00"	



102 MAIN ST.
PELLA, IA 50219
PH: (641) 621-6096

TITLE: IMPERVIA 2.0 IMPACT DIRECT SET (NON-HVHZ) (IMPACT) INSTALLATION NOTES & ANCHOR DETAILS

PREPARED BY: BUILDING DROPS, INC.
398 E. DANIA BEACH BLVD., STE. 338
DANIA BEACH, FL 33004
PH: (954)395-8478
FAX: (954)744-4738
WEB: www.buildingdrops.com



REMARKS	BY	DATE

THE INSTALLATION DETAILS DESCRIBED HEREIN ARE GENERIC AND MAY NOT REFLECT ACTUAL CONDITIONS FOR A SPECIFIC SITE. IF SITE CONDITIONS CAUSE INSTALLATION TO DEVIATE FROM THE REQUIREMENTS DETAILED HEREIN, A LICENSED ENGINEER OR ARCHITECT SHALL PREPARE SITE SPECIFIC DOCUMENTS FOR USE WITH THIS DOCUMENT.

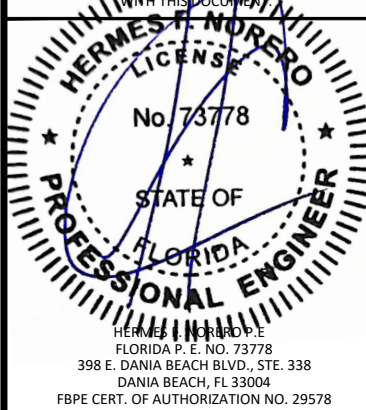

FL26584

DATE: 06/23/23

DWG. BY: OL
CHK. BY: HFN

SCALE: NTS

DWG. #: PLA001

SHEET: OF 6